

# PRIVATE EVENTS AT THE FARESTART RESTAURANT



## 700 VIRGINIA ST.

FareStart's flagship restaurant in the heart of Seattle is available for private event rentals. Conveniently located between downtown and South Lake Union, the restaurant is within walking distance of many hotels, public transportation, tourist attractions and the Washington State Convention Center.

From birthday and anniversary celebrations, to award ceremonies, receptions, meetings, holiday parties and more – the iconic FareStart Restaurant is the perfect stage to host your event. Our urban location with exposed beams, warm hues and floor to ceiling windows sets the tone for any occasion. Hosting your private event at the FareStart Restaurant will not only be a memorable event, but it will also help FareStart fulfill its mission to transform lives, disrupt poverty and nourish communities.



## VENUE HIGHLIGHTS

- Restaurant tables and chairs included
- Streaming music service available
- Full venue buy outs available
- Events from 10-200 guests
- Accommodates 200 standing/140 seated
- Multilevel seating
- Floor to ceiling windows
- Wireless microphone
- Bar structure
- Free parking after 4 p.m. weekdays and all day on weekends
- **Virtual Tour**



# SPECTACULAR EVENT SPACES FOR MEETINGS AND CELEBRATIONS

With capacity for 140 seated or 200 standing guests, a mezzanine loft space, tables and chairs, separate bar and a dramatic centerpiece counter, the FareStart Restaurant space can be easily conformed to meet all of your needs.

The multi-level venue is perfect for events large and small with varying setup needs.

## EVENT SPACE FLOOR PLAN

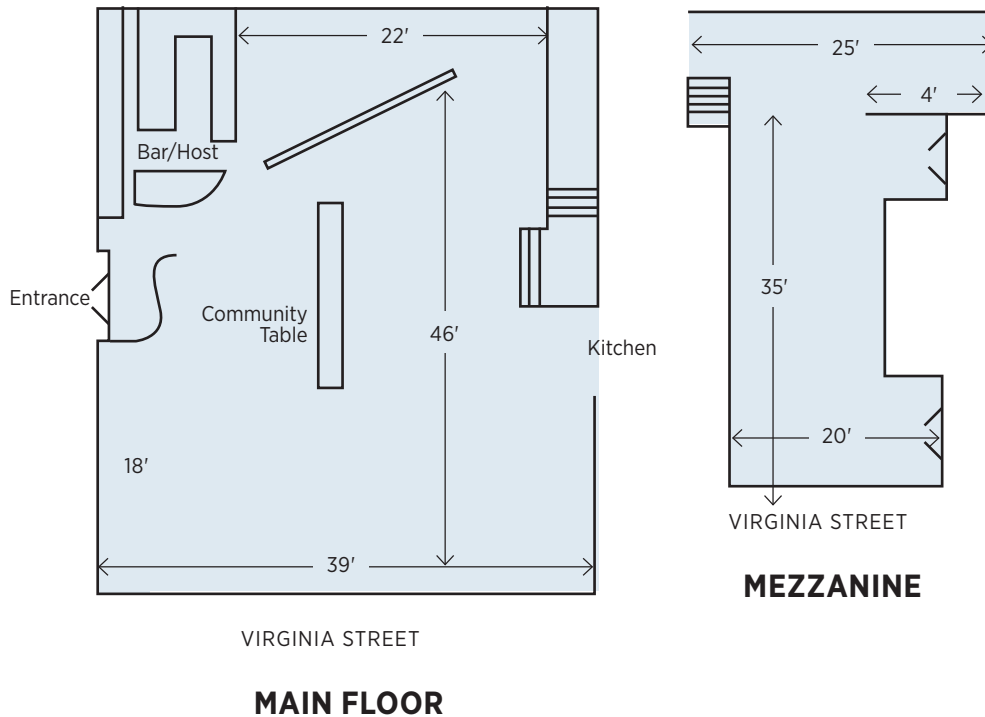

## CAPACITY CHART

| ROOM NAME       | ROOM DIMENSIONS<br>L x W x H | ROOM SIZE<br>SQ. FT. | STANDING RECEPTION | SEATED |
|-----------------|------------------------------|----------------------|--------------------|--------|
| Entire Facility | —                            | 2494                 | 200                | 140    |
| Main Floor      | 46x39                        | 1794                 | 145                | 100    |
| Mezzanine       | 35x20                        | 700                  | 55                 | 40     |

## VENUE RATES

Rental fees for our spaces vary depending on day of the week, and are subject to change. The following chart outlines our general rental rates for evening events (4 p.m. to 12 a.m.). These rates are based on a 4-hour minimum.

|                            | TIMEFRAME        | MON-THURS | FRIDAY  | SATURDAY | SUNDAY  |
|----------------------------|------------------|-----------|---------|----------|---------|
| Main Dining Room/Mezzanine | 8 a.m. - 4 p.m.  | \$1,000   | \$1,500 | \$2,500  | \$2,000 |
|                            | 4 p.m. - 12 a.m. | \$2,000   | \$3,000 | \$3,000  | \$2,500 |
|                            | 8 a.m. - 12 a.m. | \$3,000   | \$3,500 | \$3,500  | \$3,000 |